

# Decorative surface luminaire

## INSTALLATION GUIDE

990.0440.01 - 26/04/2024

### Important



The light source in this product is not replaceable. When the light source reaches its end of life, the whole luminaire shall be replaced.



Non-replaceable control gear.

For light source energy class, please refer to relevant product technical data sheet for further information.

This luminaire has an ingress protection rating of IP44 from the room side once installed.

**Please retain this guide for future reference and recycle packaging.**



# 1

Isolate mains supply before commencing installation



- Undo two grub screws, using hex key supplied and release the luminaire cover.
- Release tether clip (1) and connectors (2) to remove cover.

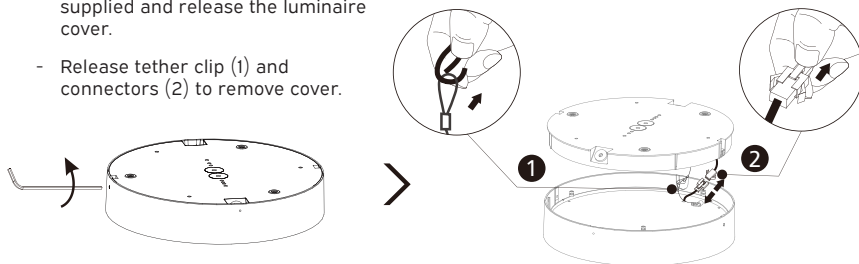

# 2

- Mark fixing positions on mounting surface and drill holes to suit fixings to be used.
- Secure fixing bracket to mounting surface using fixings appropriate for the mounting surface.

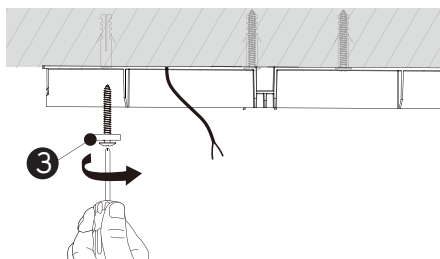

# 3

- Connect mains to terminal block.

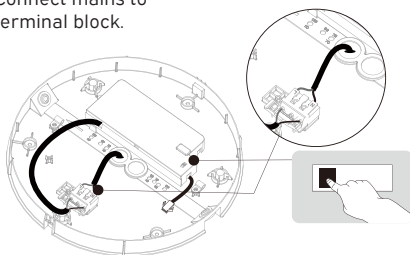

- Select required colour temperature in CCT-change function only.

Standard	DALI
N = Neutral	L = Switched
L = Switched	N = Neutral
	DA/V+ = DIM +
	DA/V- = DIM -

Wire diameter: 0.5-2.5mm<sup>2</sup>  
Wire stripping length: 8-10mm

# 4

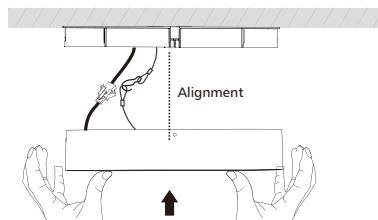

- Reconnect tether clip and connectors.
- Offer cover up to gear tray

# 5

- Hold cover in position with 2 x plastic pips then secure with 2 x grub screws.

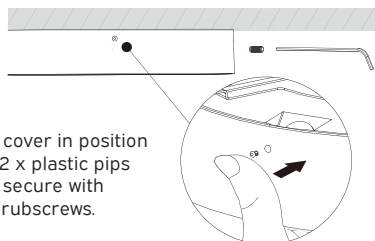

Reinstate mains supply



# Suspended Bulkhead

## INSTALLATION GUIDE

990.0440.02 - 26/04/2024

### Important



The light source in this product is not replaceable. When the light source reaches its end of life, the whole luminaire shall be replaced.



Non-replaceable control gear.

For light source energy class, please refer to relevant product technical data sheet for further information.

This luminaire has an ingress protection rating of IP44 from the room side once installed.

**Please retain this guide for future reference and recycle packaging.**



**1**

Isolate mains supply before commencing installation

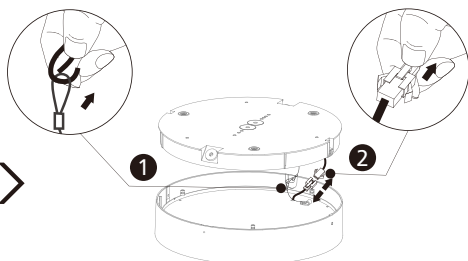
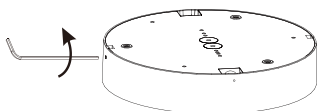

- Undo two grub screws, using hex key supplied and release the luminaire cover.
- Release tether clip (1) and connectors (2) to remove cover.

**2**

- Unscrew 3 x fixing plates from suspension caps supplied with ceiling rose assembly.

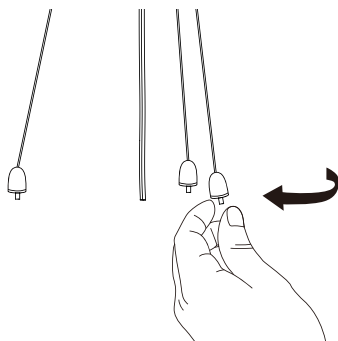
**3**

- Attach 3 x fixing plates to back of gear tray using machine screws supplied.

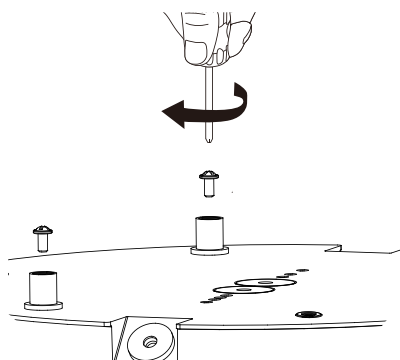
**4**

- Re-attach 3 x suspension caps to gear tray assembly.

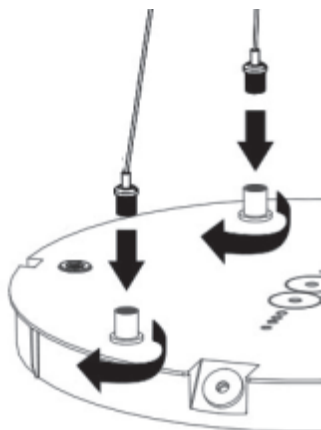
**5**

- Feed supply cable from ceiling rose through grommet in gear tray and fit strain relief as shown.

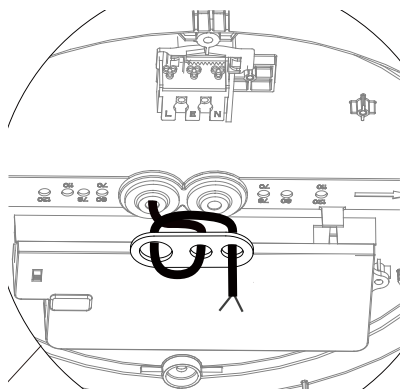

# 6

- Connect supply cable to terminal block.

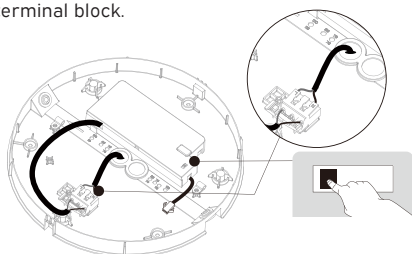

- Select desired colour temperature (3 CCT variants only).

Standard	DALI
<p>N = Neutral L = Switched</p>	<p>L = Switched N = Neutral DA/V+ = DIM+ DA/V- = DIM-</p>

Wire diameter: 0.5-2.5mm<sup>2</sup>  
Wire stripping length: 8-10mm

# 7

- Reconnect tether clip and connectors (1).
- Offer cover up to gear tray (2)
- Secure cover with 2 x grubscrews (3)

