

INSTALLATION GUIDE:

LED DOWNLIGHT
990.0384.01

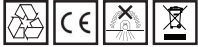

IMPORTANT:

The luminaire must not be covered by any debris or insulating material. Ensure there is a minimum of 50 mm airspace around the luminaire and control gear. Electrical termination must be carried out by a qualified electrician in accordance with the latest edition of IEE wiring regulations BS7671.

NOTE: THE LED MODULES IN THIS LUMINAIRE ARE NON-USER REPLACEABLE.

PLEASE RETAIN THIS GUIDE FOR FUTURE REFERENCE AND RECYCLE PACKAGING.

A



ISOLATE MAINS SUPPLY BEFORE COMMENCING INSTALLATION

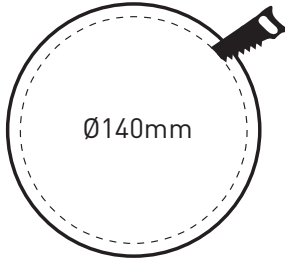

- Cut a 140 mm circular hole at the desired location using a holesaw.

B

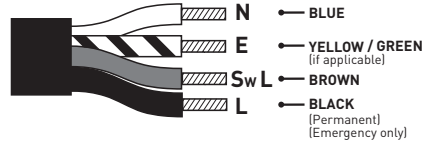

- Connect the luminaire to the mains supply using a terminal block (not supplied) compliant with the requirements of EN60998-2-1 or 2-2.
- For Touch & Dim wiring see instruction leaflet **990.0009.01**.
- For DALI wiring see instruction leaflet **990.0028.01**.

C

- Insert the driver into the ceiling void.

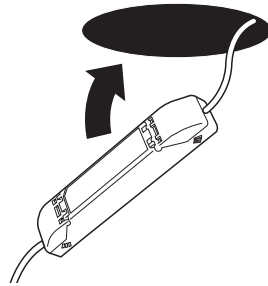

D

- Do not cover the heatsink whilst in the ceiling
- Retract the fixing springs and insert the fitting into the ceiling void.
- Fitting angle and orientation can be adjusted from below.

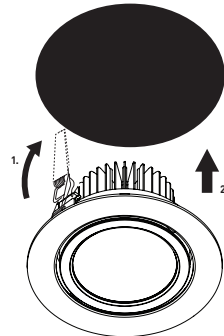

REINSTATE MAINS SUPPLY