

# INSTALLATION GUIDE:

EXTRUDED DIRECT LINEAR - SURFACE MOUNTED  
990.0365.01



## IMPORTANT:

Electrical termination must be carried out by a qualified electrician in accordance with the latest edition of IEE wiring regulations BS7671.

**ENSURE MOUNTING SURFACE IS CAPABLE OF SUPPORTING THE WEIGHT OF THE LUMINAIRE**

PLEASE RETAIN THIS GUIDE FOR FUTURE REFERENCE AND RECYCLE PACKAGING.

### A ISOLATE MAINS SUPPLY BEFORE COMMENCING INSTALLATION

0.85 m Length 2.5 kg

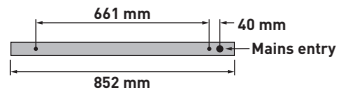

1.2 m Length 3.5 kg



1.5 m Length 4.3 kg



2.5 m Length 7.3 kg

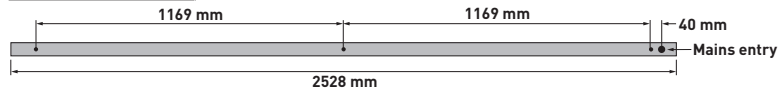

### IMPORTANT: DO NOT USE POWER TOOLS TO TIGHTEN FIXINGS ON THIS LUMINAIRE

- Ensure the mounting surface is flat and even.
- Mark out positions of fixing holes on ceiling, depending upon length of luminaire.
- If suspended, see separate installation guide 990.0372.01 for suspension installation.

**On emergency converted 2.5 m lengths, only the LED tray containing the charge indicator will illuminate in emergency mode**

### D

- Disconnect the driver connectors and the earth spade to release the LED tray.
- Offer the luminaire body up to the ceiling and feed mains cable into it.
- Attach the luminaire body to the ceiling using suitable fixings (not supplied).
- If suspended, see separate installation guide 990.0372.01 for suspension installation.

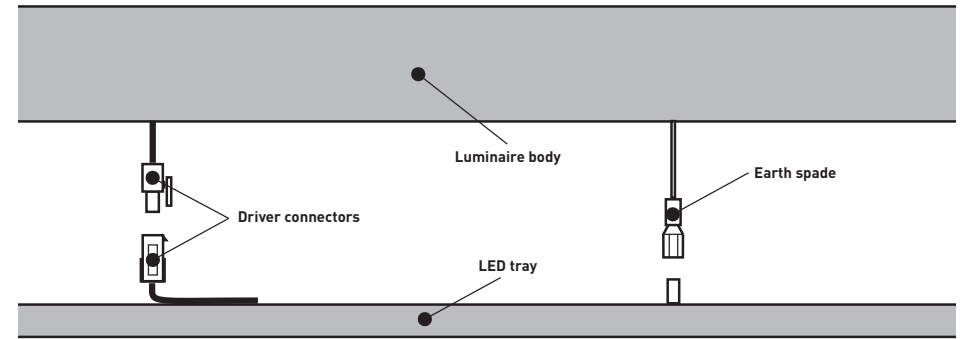

### B

- Prise out the diffuser using a plastic lever tool (not supplied) or card, starting in the centre of the diffuser and working outwards.
- Please note: Do not use metal tools such as screwdrivers to do this as they may damage the diffuser / body

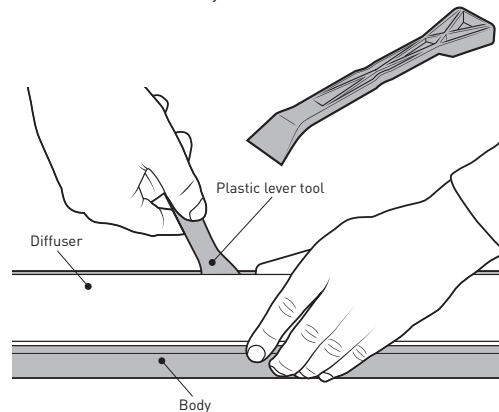

### C

- Using a terminal driver, ease out the LED tray retaining clips, whilst pulling the tray up, one at a time and remove the downlight LED tray as shown.
- Slide tray to one end and remove

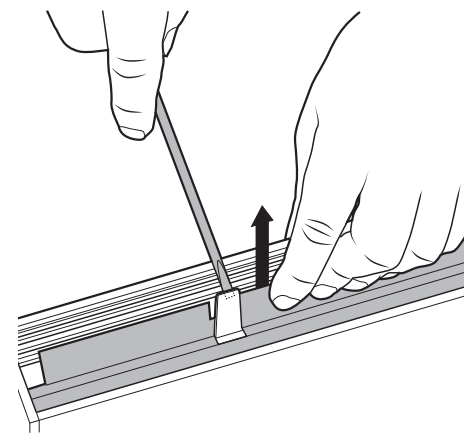

### E

- Connect mains supply to terminal block.
- For switch dim, link D2 to N and connect D1 to mains supply via a push to make retractive switch.

#### STANDARD

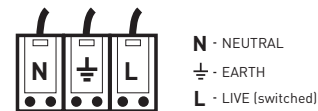

#### EMERGENCY

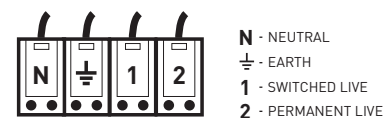

#### DIMMING



### F

- Offer up the LED tray and reconnect the driver connectors and the earth spade.
- Push the LED tray into the body ensuring the clips are correctly aligned and secure and no wires are trapped.
- Push the diffuser back into the luminaire until secure.

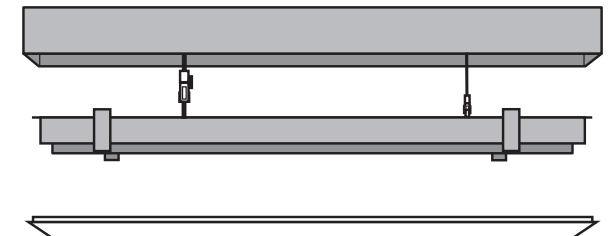

**REINSTATE MAINS SUPPLY**

## INSTALLATION GUIDE:

SUSPENDED DIRECT LINEAR - JOINING KITS

990.0374.01



### IMPORTANT:

Electrical termination must be carried out by a qualified electrician in accordance with the latest edition of IEE wiring regulations BS7671.

PLEASE RETAIN THIS GUIDE FOR FUTURE REFERENCE AND RECYCLE PACKAGING.

### IN-LINE JOINT

PERFORM INSTALLATION BEFORE CLIPPING  
GEAR TRAY AND DIFFUSER BACK INTO LUMINAIRE

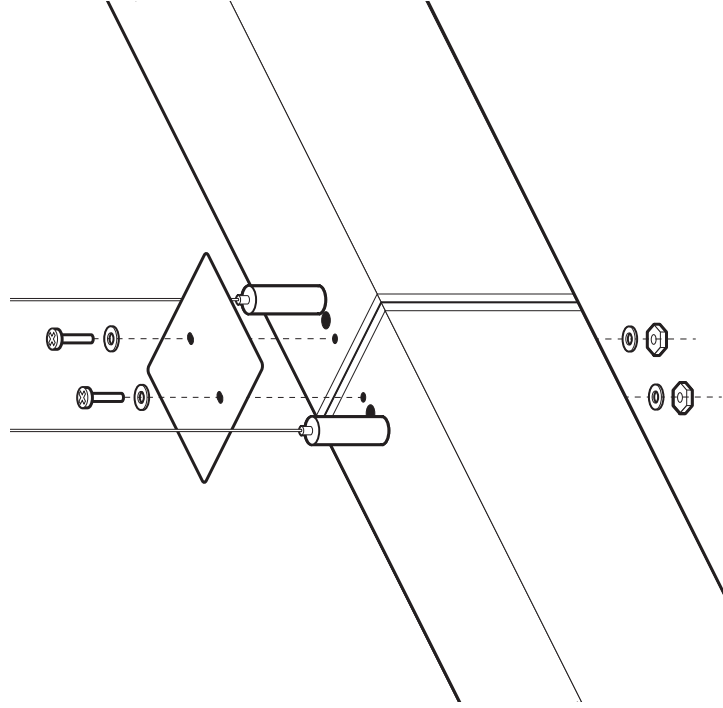

### 90° JOINT

PERFORM INSTALLATION BEFORE CLIPPING  
GEAR TRAY AND DIFFUSER BACK INTO LUMINAIRE

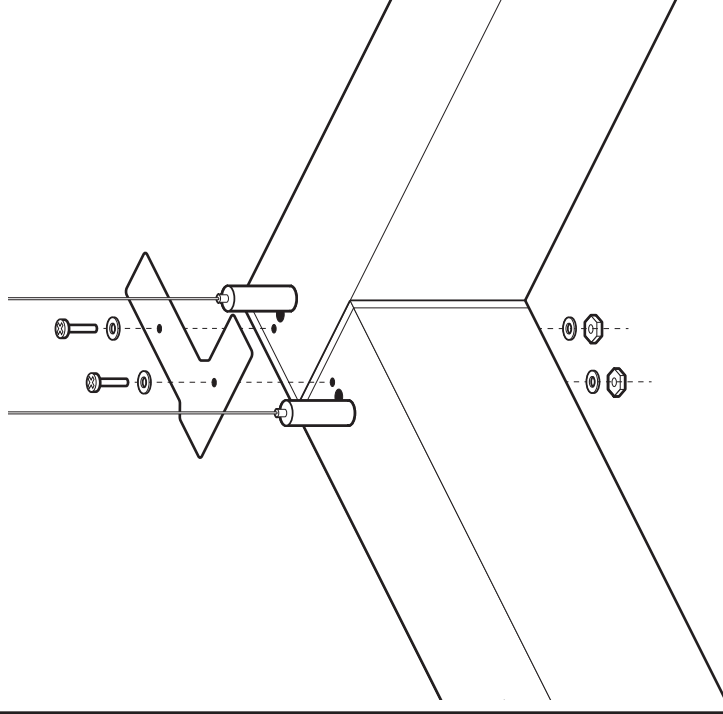

# INSTALLATION GUIDE:

EXTRUDED DIRECT LINEAR - SUSPENSION KIT  
990.0372.01



**IMPORTANT:**  
Electrical termination must be carried out by a qualified electrician in accordance with the latest edition of IEE wiring regulations BS7671.

**ENSURE MOUNTING SURFACE IS CAPABLE OF SUPPORTING THE WEIGHT OF THE LUMINAIRE.**

PLEASE RETAIN THIS GUIDE FOR FUTURE REFERENCE AND RECYCLE PACKAGING.

## A ISOLATE MAINS SUPPLY BEFORE COMMENCING INSTALLATION

## IMPORTANT: DO NOT USE POWER TOOLS TO TIGHTEN FIXINGS ON THIS LUMINAIRE

0.85 m Length  2.5 kg

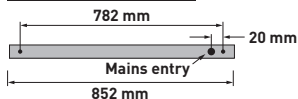

1.2 m Length  3.5 kg

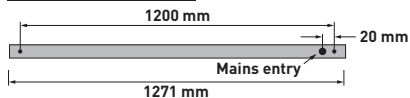

1.5 m Length  4.3 kg

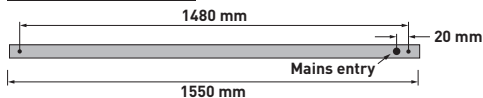

2.5 m Length  7.3 kg

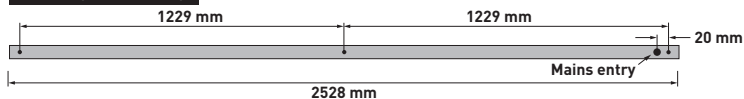

- Mark out positions of fixing points on ceiling, depending upon length of luminaire.
- Attach the ceiling cup assemblies to the ceiling using suitable fixings (not supplied).

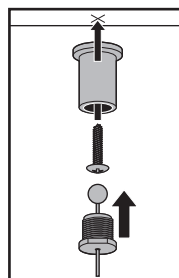

- ## B
- Follow luminaire installation guide 990.0365.01 steps **B**, **C** & **D** (1st point only)
  - Attach the suspension clutches and cable gland as shown

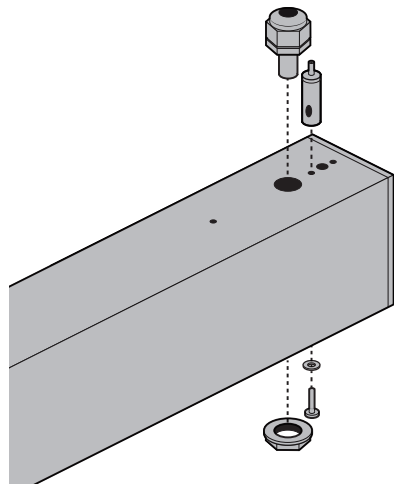

- ## C
- Offer the luminaire up to the required position
  - Thread the suspension cables through the suspension clutches
  - Level the luminaire (to adjust the luminaire downwards, support the weight of the luminaire then press down the nipple to release the clutch)
  - Feed the mains cable into the luminaire and secure the cable gland
  - Continue to follow luminaire installation guide 990.0365.01 from step **E**

