

# INSTALLATION GUIDE:

WALL LIGHT  
990.0348.01



## IMPORTANT:

The luminaire must not be covered by any debris or insulating material. Ensure there is a minimum of 50 mm airspace around the luminaire and control gear. Electrical termination must be carried out by a qualified electrician in accordance with the latest edition of IEE wiring regulations BS7671.

**PLEASE RETAIN THIS GUIDE FOR FUTURE REFERENCE AND RECYCLE PACKAGING.**

### A ISOLATE MAINS SUPPLY BEFORE COMMENCING INSTALLATION

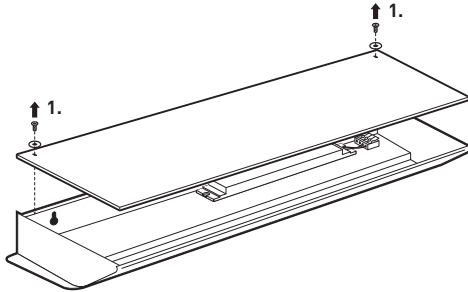

- Unscrew and remove the two screws from top of fitting as indicated (1).
- Carefully remove the diffuser.

### B

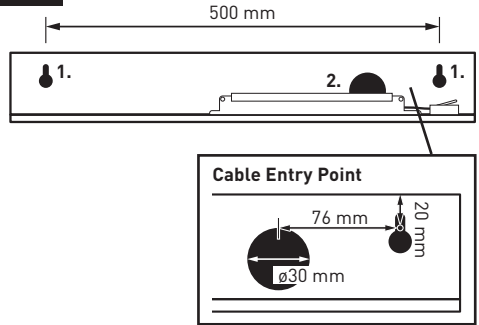

- Mark mounting dimensions on wall in desired location as indicated (1), note cable entry point.
- Drill mounting holes.
- Screw in suitable fixings (not supplied) leaving a 5 mm gap from wall to head of screw.
- Feed mains supply through the hole on the fitting (2).
- Place fitting on mounting surface by slotting the key holes on the fitting to the screws on the wall.
- Tighten screws until fitting is secure to wall.

### C

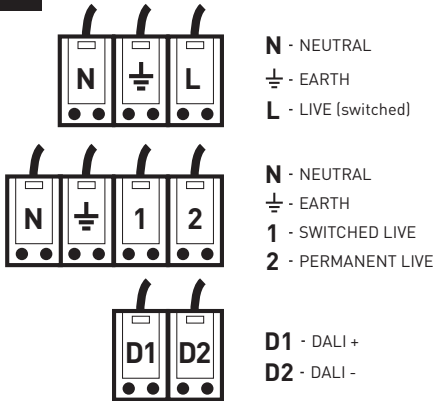

- Connect mains supply to terminal block.
- For switch dim link D2 to N, connect D1 to mains supply via a push to make retractive switch.

### D

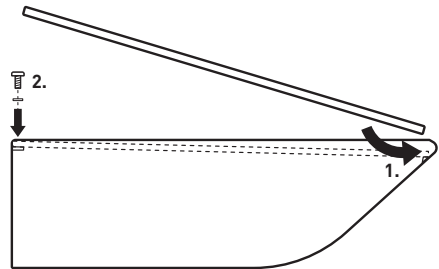

- Replace diffuser on to the fitting at a 45° angle so it goes under the lip of the fitting as shown, then lower rest of the diffuser into place (1).
- Re-fit screws on to fitting and diffuser as before until secure (2).



**REINSTATE MAINS SUPPLY**