

LED downlight

INSTALLATION GUIDE

990.0431.01 - 02/11/2023

Important



The light source and control gear in this luminaire shall only be replaced by the original manufacturer, service agent or a similarly qualified person.

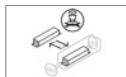

Please refer to product technical datasheet for light source energy class information.

Any ingress protection rating stated on the product label is from the room side once installed.



This luminaire must not be covered with thermally insulating material.



Please retain this guide for future reference and recycle packaging.



NOTE: Luminaire style may vary

1

Isolate mains supply before commencing installation

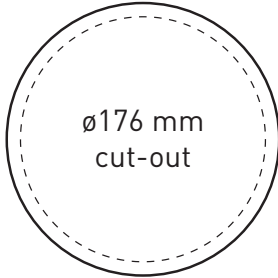
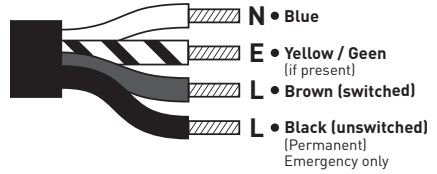

- Cut a 176 mm hole at required location using a hole saw.

**2**

- Terminal block not included. Installation must be performed by a qualified person in accordance with the latest edition of the IEE wiring regulations BS7671.
- If no terminal block is available, carefully remove supply leads from control gear and connect directly into terminals, taking care to follow markings on housing.
- For variants fitted with DALI control gear, please refer to supplementary installation guide.

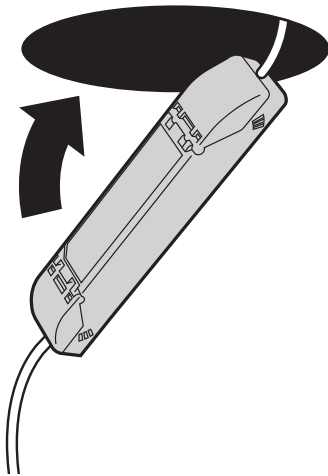
3

- Insert driver into ceiling void.

Note: Driver style may vary

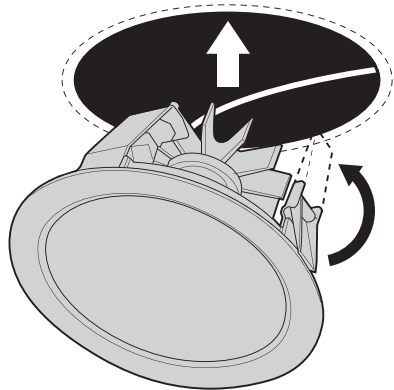
4

- Retract fixing springs and insert luminaire into ceiling aperture, ensuring there is at least 50 mm air space around the luminaire body and all control gear.

Note: Luminaire style may vary

Reinstate mains supply



LED downlight

INSTALLATION GUIDE

990.0432.01 - 03/11/2023

Important



The light source and control gear in this luminaire shall only be replaced by the original manufacturer, service agent or a similarly qualified person.

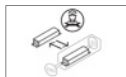

Please refer to product technical datasheet for light source energy class information.

Any ingress protection rating stated on the product label is from the room side once installed.



This luminaire must not be covered with thermally insulating material.



Please retain this guide for future reference and recycle packaging.



NOTE: Luminaire style may vary

1

Isolate mains supply before commencing installation

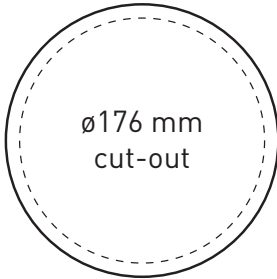
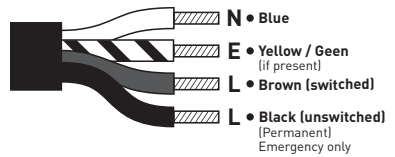

- Cut a 176 mm hole at required location using a hole saw.

**2**

- Terminal block not included. Installation must be performed by a qualified person in accordance with the latest edition of the IEE wiring regulations BS7671.
- If no terminal block is available, carefully remove supply leads from control gear and connect directly into terminals, taking care to follow markings on housing.
- For variants fitted with DALI control gear, please refer to supplementary installation guide.

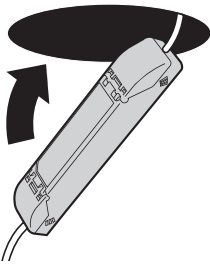
3

- Insert driver into ceiling void.

Note: Driver style may vary

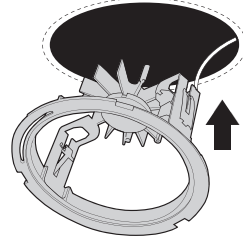
4

- Carefully remove reflector and insert luminaire into ceiling aperture, ensuring there is at least 50 mm air space around luminaire body and all control gear.

Note: Luminaire style may vary

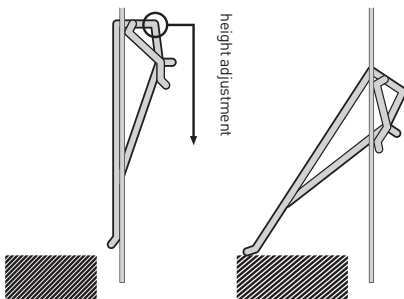
5

- Lock luminaire in position by adjusting fixing springs as shown.

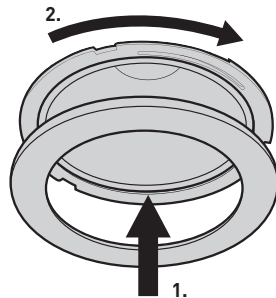
6

- Carefully relocate reflector and fit twist & lock bezel with any decorative accessory to hold reflector in place.

Reinstate mains supply



LED downlight with IP65 accessory

INSTALLATION GUIDE

990.0436.01 - 08/11/2023

Important



The light source and control gear in this luminaire shall only be replaced by the original manufacturer, service agent or similarly qualified person.



Please refer to product technical datasheet for light source energy class information.

Any ingress protection rating stated on the product label is from the room side once installed.



This luminaire must not be covered with thermally insulating material.



Please retain this guide for future reference and recycle packaging.



NOTE: Luminaire style may vary

1

Isolate mains supply before commencing installation

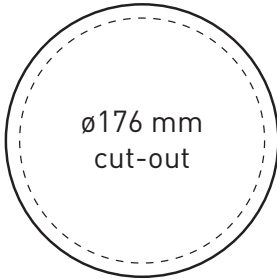
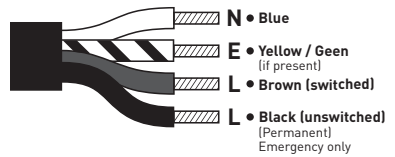

- Cut a 176 mm hole at required location using a hole saw.

**2**

- Terminal block not included. Installation must be performed by a qualified person in accordance with the latest edition of the IEE wiring regulations BS7671.
- If no terminal block is available, carefully remove supply leads from control gear and connect directly into terminals, taking care to follow markings on housing.
- For variants fitted with DALI control gear, please refer to supplementary installation guide.

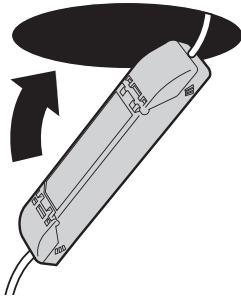
3

- Insert driver into ceiling void.

Note: Driver style may vary

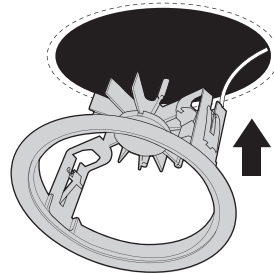
4

- Carefully remove reflector and insert luminaire into ceiling aperture, ensuring there is at least 50 mm air space around luminaire body and all control gear.

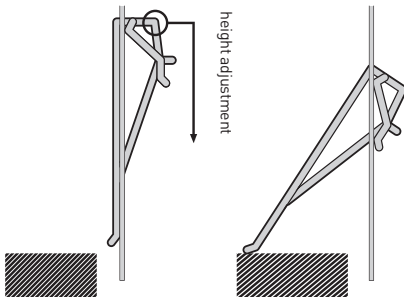
5

- Lock luminaire in position by adjusting fixing springs as shown.

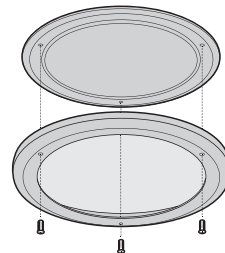
6

- Carefully relocate reflector and fit IP65 bezel using 3x screws supplied.
- Do not over-tighten. Do not use electric screwdriver as this may damage seal or luminaire.

Reinstate mains supply

